



4 3 3

**Contact** Troy Holmes  
0414 344 442

**Type** House

**Sold Date** 31/01/2019

**Land** 875 m2

Set into astonishingly beautiful showpiece gardens, this grand dame of architectural elegance brings a slice of vintage, sanctuary-style living to a premium Glen Alpine cul-de-sac. Simply in its own category, the property's innumerable highlights include a gourmet kitchen with triple-bevelled edge marble benchtops, taffeta curtains and imported French terracotta tiles, all-seasons outdoor entertaining and a luxury Riviera saltwater pool. High ceilings, rich maple and walnut finishes, multiple fireplaces and ornate mantels typify the supreme quality and peerless craftsmanship of an awe-inspiring family address.

- High-side street setting with golf course frontage and Mt Annan views
- Generous formal and informal living zones, home theatre plus office
- In-ground pool with aqua jets and Bundanoon sandstone feature wall

\*Please



FIRST LEVEL



MAIN LEVEL

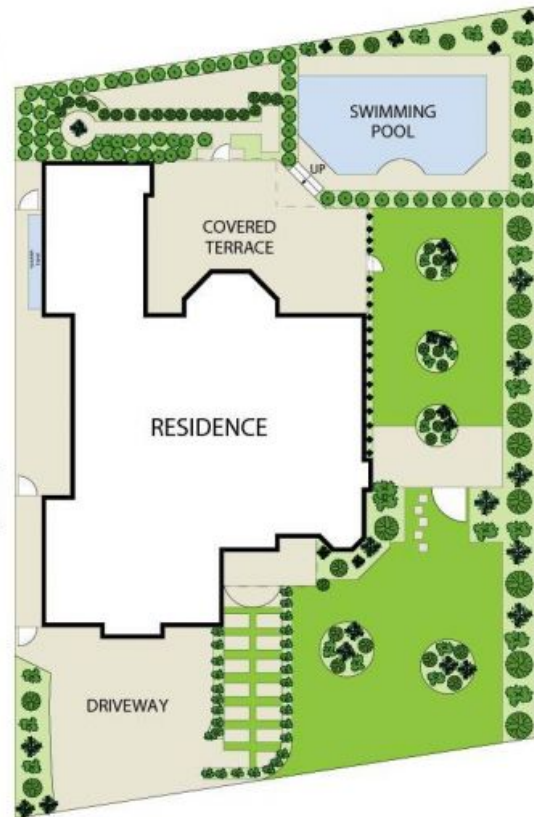

SITE PLAN



## 10 Gracemere Place, Glen Alpine

**Floor Plan Disclaimer:** MTG Media floor plans / site plans are intended as an approximate guide only. No representations or warranties of any nature are given or intended and any person or company using this information other than as a guide should always rely on their own enquiries. MTG Media marketing services - 1300 133 145 - Photography, Floor plans, Copywriting, Video, Drone - [www.mtgmedia.com.au](http://www.mtgmedia.com.au)