



4  2  5 

Contact Troy Holmes
0414 344 442

Type House

Sold Date 07/01/2022

Land 1122 m2

MARKET BUY SALE: This property is being sold via Market Buy. Speak to your agent at the inspection for more details.

- High-end family entertainer with occupation certificate in place
- Formal and informal lounge and dining, sleek double-sided fireplace
- Bespoke kitchen with waterfall-edge stone tops, large walk-in pantry
- Opulent master ensuite plus walk-in robe, private lounge and study/gym
- Sophisticated electrical system including top-of-the-range ducted air
- Sunny wraparound patio, level child-friendly lawn ? landscape to taste
- DLUG plus three-car garage with provisions for bath and kitchenette
- Extensive scope for capital growth in a thriving lifestyle suburb



ENTRY LEVEL

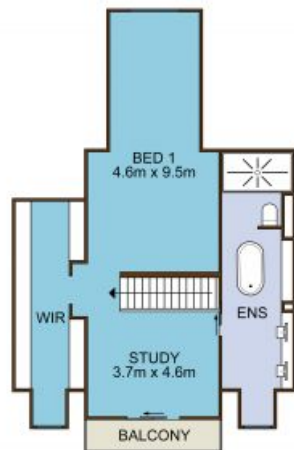

UPPER LEVEL

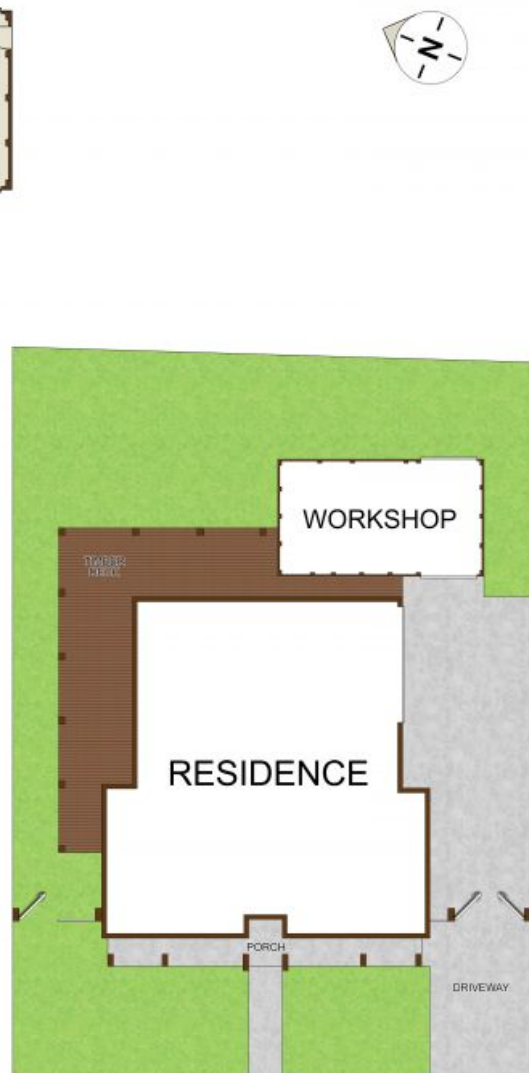

SITE PLAN

HOLMES
REAL ESTATE

26 Fairway Drive, WILTON

Not to scale • All measurements are approximate • Drawn for marketing purposes only