



5  2  2 

Contact Troy Holmes
0414 344 442

Type House

Sold Date 24/04/2023

Land 629 m2

Strong in designer impact while providing all the space and substance you crave, this charismatic high-side home is the total package. Its stunning new matte black kitchen takes centre stage, showcasing waterfall-edge stone benchtops, 900mm gas cooking and a breakfast bar; beautifully proportioned living areas, a formal dining room and uninterrupted alfresco flow create an atmosphere of relaxed luxury. Low-maintenance entertainer and classic hideaway all in one, it's ready to impress in arguably one of the suburb's best streets moments from bushwalks, buses and the primary school.

- Recently renovated with new floors and fresh paintwork throughout
- Formal and informal lounges, stacker doors to patio and N/E facing yard
- Gourmet chef's kitchen, sleek new laundry and guest powder room
- A/C, security shutters plus alarm, three huge rainwater tanks, DLUG



ENTRY LEVEL



SITE PLAN

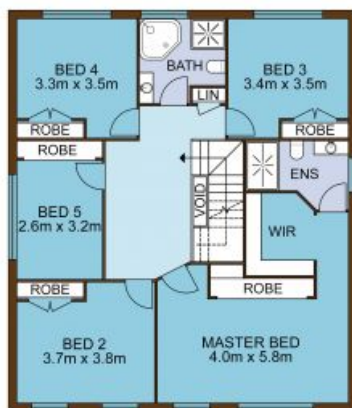

UPPER LEVEL

HOLMES
REAL ESTATE

39 Crommelin Crescent, SAINT HELENS PARK

Not to scale • All measurements are approximate • Drawn for marketing purposes only