



3 2 2

Contact Troy Holmes
0414 344 442

Type House

Land 653 m2

Carparks 1

Unveiling a sleek one-level floor plan suited to young family lifestyles, this comfortable home takes pride in its blend of modern living and captivating convenience. Boasting crisp, easy-care interiors dressed in neutral tones, a full master suite, generous storage and a new stone kitchen, it also provides lovely undercover entertaining and a solar-heated plunge pool ? all against a private reserve backdrop. The secluded yet ultra-central setting is second to none, giving easy access to Ingleburn shops, three local schools and Macarthur Square and Liverpool transport.

- Beautifully maintained brick residence set at the top of the street
- Tile flooring and downlights, air-conditioning unit, camera security
- Very neat child-friendly backyard, sparkling saltwater pool and Bali hut
- Great-sized kitchen with stone benchtops and 900mm electric range



GROUND FLOOR

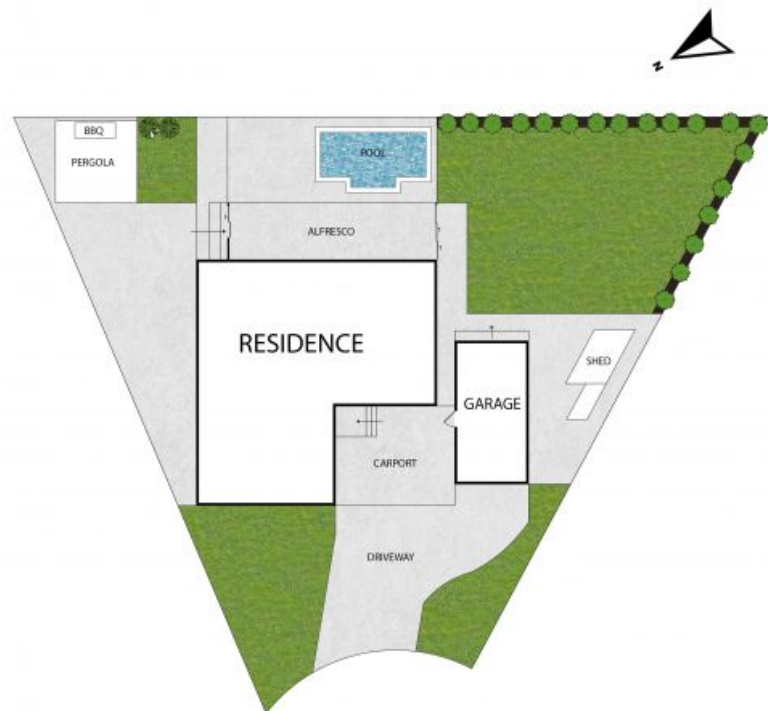

SITE PLAN